

Round Jet Nozzles

Type 4

Material: Hardened Stainless Steel
Tungsten Carbide and Ceramic - special order.

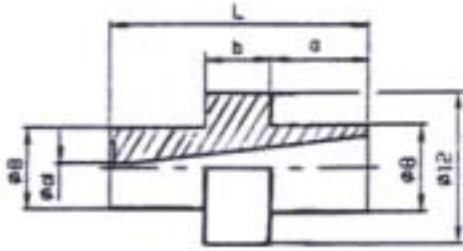

Accessories: page 6

Nozzle Type	Ø d (mm)	L (mm)	a (mm)	b (mm)	Working Pressure max. bar / PSI
Type 4	0.50 - 5.00	24	11.5	3.5	1,500 / 20,000

Type 1

Material: Hardened Stainless Steel
Tungsten Carbide and Ceramic - special order.

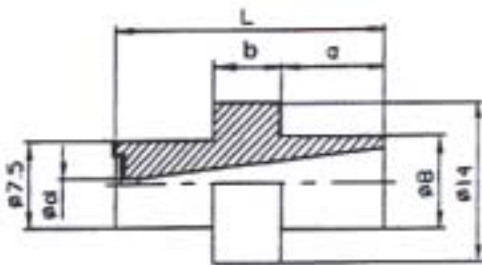

Accessories: page 6

Nozzle Type	Ø d (mm)	L (mm)	a (mm)	b (mm)	Working Pressure max. bar / PSI
Type 1	0.50 - 5.00	24	9	6	2,000 / 30,000