

Fan Jet Nozzles

Type 5

Material: Stainless Steel

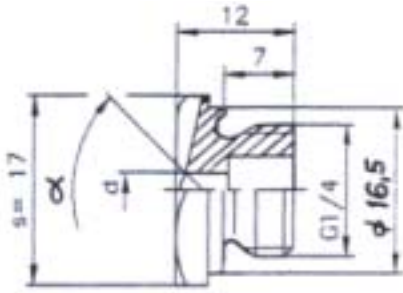

Maximum Working Pressure: 750 bar / 10,500 PSI
 Thread: 1/4" BSP
 Accessories: O-Ring
 Spraying Angle: 10° / 15° / 20° / 30° / 45° / 60°

Nozzle Type	Thread	Ø d (mm)	Working Pressure max. bar / PSI	Spraying Angle
Type 5	1/4" BSP	0.60 - 5.00	750 / 10,500	10° / 15° / 20° / 30° / 45° / 60°

Type 608

Material: Stainless Steel

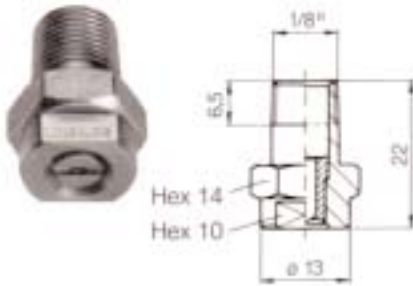

Series 608, weight: 13 g

Type 602

Material: Stainless Steel



Series 602, weight: 18 g

Nozzle Type	Thread	Ø d (mm)	Working Pressure max. bar / PSI	Spraying Angle
Type 608	1/8" NPT	1.00 - 4.00	750 / 10,500	15° / 25° / 40° / 65°
Type 602	1/4" NPT	1.00 - 4.00	750 / 10,500	15° / 25° / 40° / 65°