

1/4" & 5/16" UNF Micro Jets

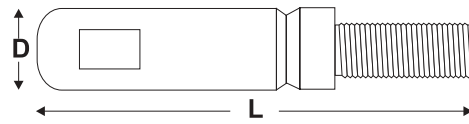

Material: Stainless Steel

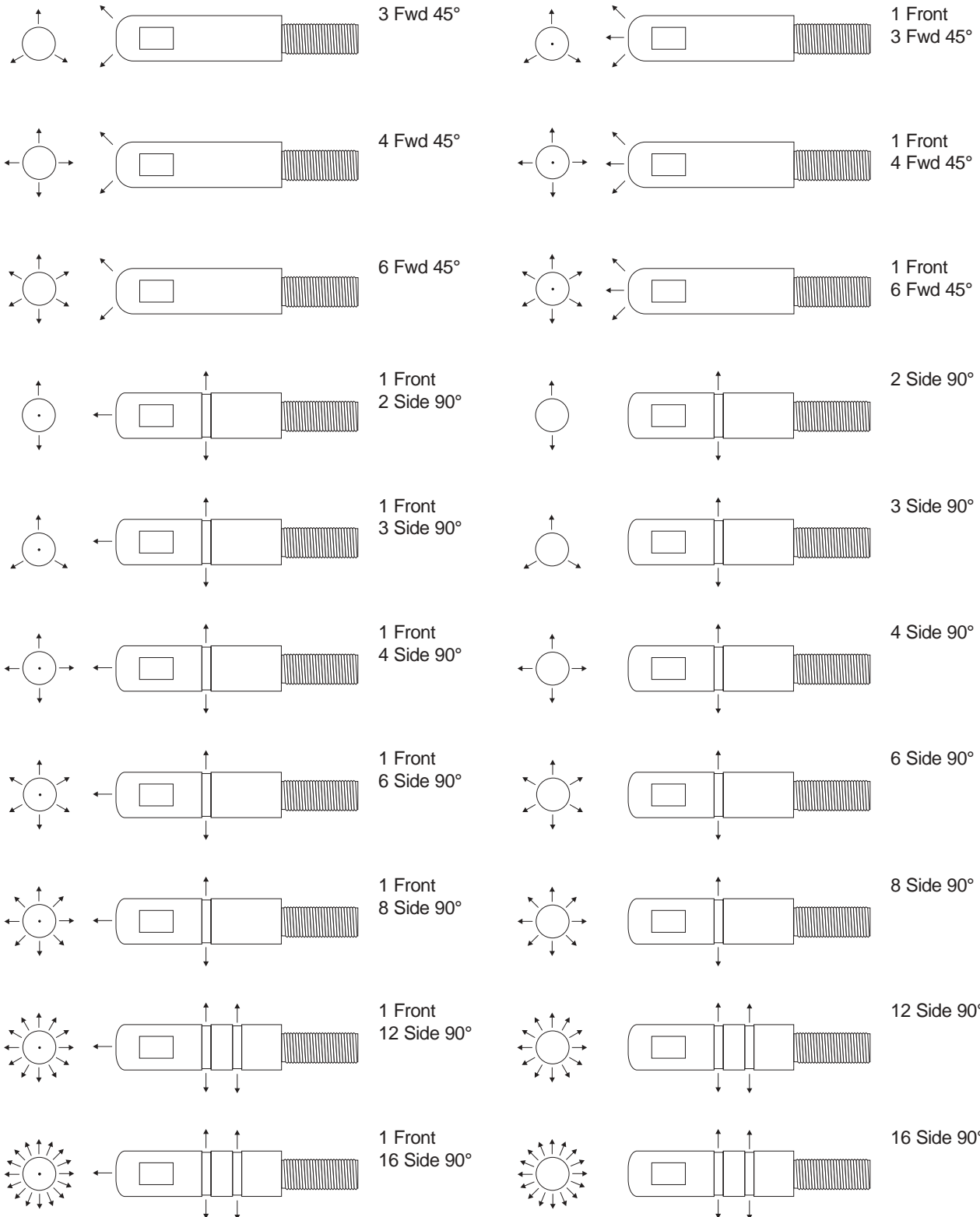

Nozzle Type	Dimensions L x DØ (mm)	Connection T	Orifices	Working Pressure max. bar / PSI
MMJ14	47 x 8	1/4" UNF	Drilled	1,000 / 15,000
MMJ516	47 x 10	5/16" UNF	Drilled	1,000 / 15,000

1/4" & 5/16" UNF Micro Jets



Material: Stainless Steel

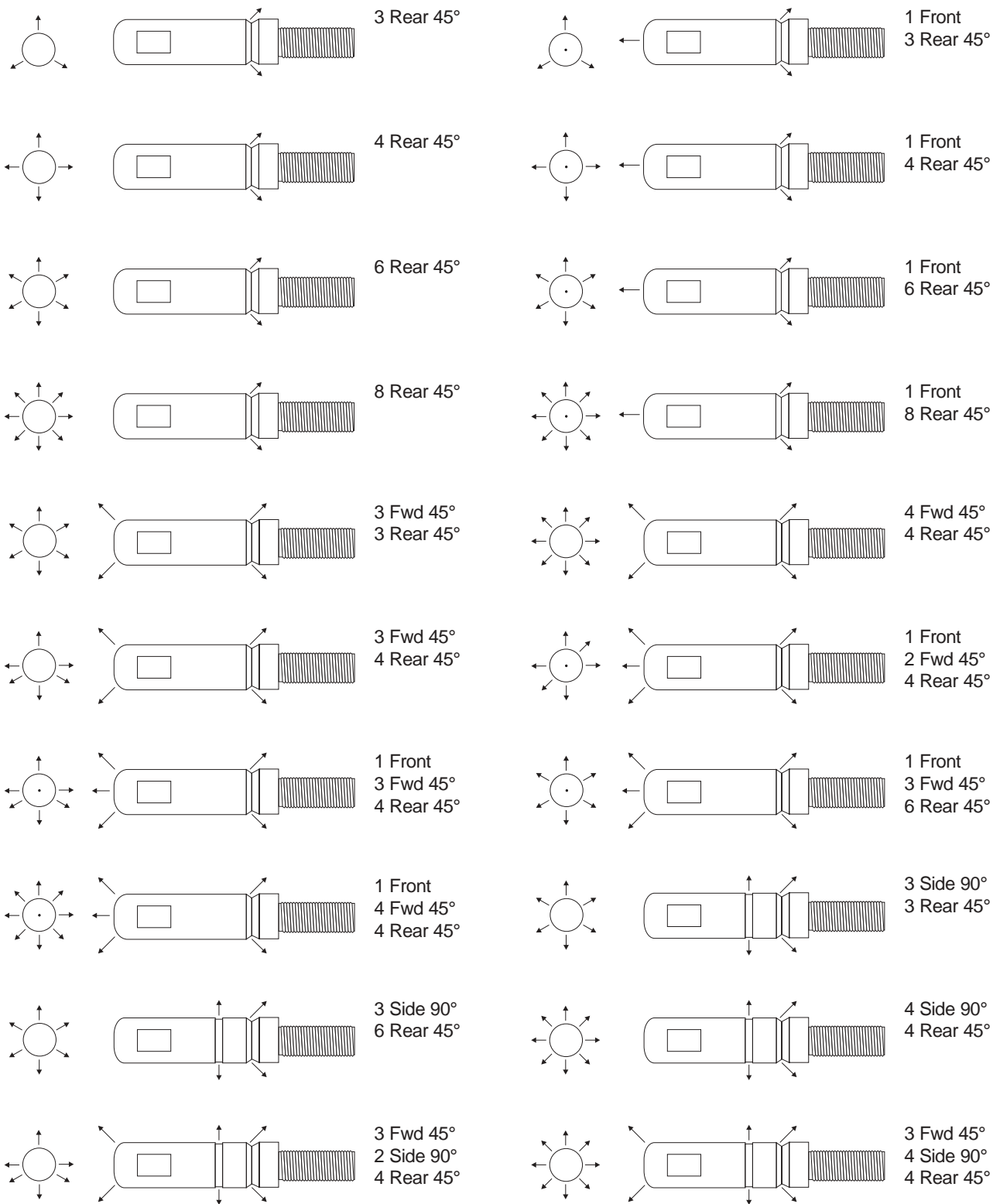
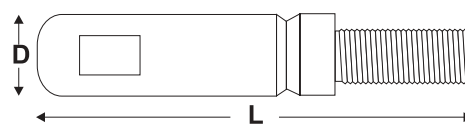

Nozzle Type	Dimensions L x DØ (mm)	Connection T	Orifices	Working Pressure max. bar / PSI
MMJ14	47 x 8	1/4" UNF	Drilled	1,000 / 15,000
MMJ516	47 x 10	5/16" UNF	Drilled	1,000 / 15,000