

Type SIBR



Rotating Nozzle Type SIBR

Characteristics:

- 2 jets 90° rotating to the side and 2 jets 45° back rotating.
- Most popular nozzle and suitable for all the general cleaning jobs. Because of the 45° back jet easy to use in combination with a flexible hose.
- Available with one or more front jets to remove any blockages.
- By reversing the rotor, the nozzle can also be used on a rigid lance or lancing machine.

Recommendation:

- If the diameter of the tube is greater than the length of the nozzle, always use a rigid extension lance between the flexible hose and the nozzle.

Notes:

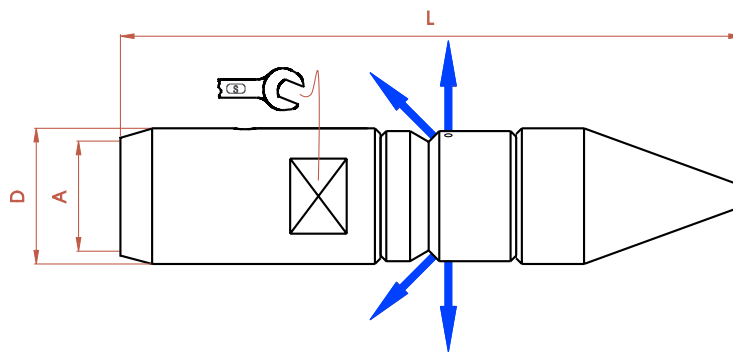

Type SIBR

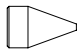
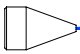
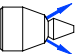
| D mm | L mm | S mm | A | Part Number | | | Max. W.P. Bar/PSI |
|---------|--------------|-----------|---------------|---|--|---|----------------------|
| | | | |  |  |  | |
| ø6 | 40 | 4 | M5M | 6006.2 | 6006.21 | 6006.2105 | 400/5.700 |
| ø8 | 43 | 6 | M6F | 6008.2 | 6008.21 | 6008.2105 | |
| ø10 | 50 | 8 | M7x1F | 6010.2 | 6010.21 | 6010.2106 | 1000/15.000 |
| | | | 1/16"NPTF | 6010.2116 | 6010.21116 | 6010.210616 | |
| | 1/4"UNFMPLHF | | 6010.214ML | 6010.2114ML | 6010.210614ML | 1500/21.500 | |
| | 1/4"UNFMPRHF | | 6010.214MR | 6010.2114MR | 6010.210614MR | | |
| 56 | 5/16"UNFM | 6010.2516 | 6010.21516 | 6010.2106516 | 1000/15.000 | | |
| ø12 | 55 | 10 | 1/8"BSPF | 6012.2 | 6012.21 | 6012.2106 | 1250/18.000 |
| | | | 1/8"NPTF | 6012.218 | 6012.2118 | 6012.210618 | |
| | | | 3/8"UNFMPLHF | 6012.238ML | 6012.2138ML | 6012.210638ML | 1500/21.500 |
| | | | 3/8"UNFMPRHF | 6012.238MR | 6012.2138MR | 6012.210638MR | |
| ø16 | 71 | 13 | 1/8"BSPF | 6016.2 | 6016.21 | 6016.2106 | 1000/15.000 |
| ø18 | 64 | 16 | 1/4"BSPF | 6018.2 | 6018.21 | 6018.2106 | |
| | | | 1/4"NPTF | 6018.214 | 6018.2114 | 6018.210614 | |
| | | | 9/16"UNFMPLHF | 6018.2916ML | 6018.21916ML | 6018.2106916ML | 1500/21.500 |
| | | | 9/16"UNFMPRHF | 6018.2916MR | 6018.21916MR | 6018.2106916MR | |
| ø22 | 82 | 19 | 1/4"BSPF | 6022.2 | 6022.21 | 6022.2106 | 1000/15.000 |
| | | | 3/8"NPTF | 6022.238N | 6022.2138N | 6022.210638N | |
| | | | 3/8"BSPF | 6022.238 | 6022.2138 | 6022.210638 | |
| ø28 | 77 | 25 | 1/4"BSPF | 6028.2 | 6028.21 | 6028.2108 | 1250/18.000 |
| | 88 | | 1/2"BSPM | 6028.2.12M | 6028.21.12M | 6028.2108.12M | |
| | 82 | 26 | 1/2"NPTF | 6028.2.12N | 6028.21.12N | 6028.2108.12N | |
| | 88 | 25 | 3/8"BSPM | 6028.2.38M | 6028.21.38M | 6028.2108.38M | |
| | 93 | | M22x1,5M | 6028.2.22M | 6028.21.22M | 6028.2108.22M | |
| ø40 | 97 | - | M24x1,5F | 6040.2 | 6040.21 | 6040.2108 | 1250/18.000 |
| | 124 | | 1/4"BSPF | 6040.2.14F | 6040.21.14F | 6040.2108.14F | |
| | 127 | 27 | 1/4"BSPM | 6040.2.14M | 6040.21.14M | 6040.2108.14M | |
| | | | 3/8"BSPM | 6040.2.38 | 6040.21.38 | 6040.2108.38 | |
| | | | 1/2"BSPM | 6040.2.12 | 6040.21.12 | 6040.2108.12 | |
| 132 | 27 | M22x1,5M | 6040.2.22 | 6040.21.22 | 6040.2108.22 | | |

M= Male thread
F= Female thread