

Rotary Nozzle RTV

The Rotating Nozzle with RTV-Rotor is equipped with water jets directed forwards to the pipe wall as well as with a central front jet and 3 thrust jets backwards, making it possible to advance into a blocked pipe. The front jet loosens the material and the tangential jets break up all sorts of deposits. The thrust jets drive the nozzle forwards and also flush back the loosened material.

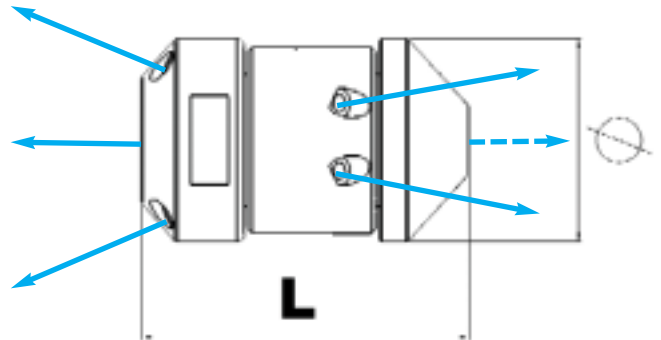
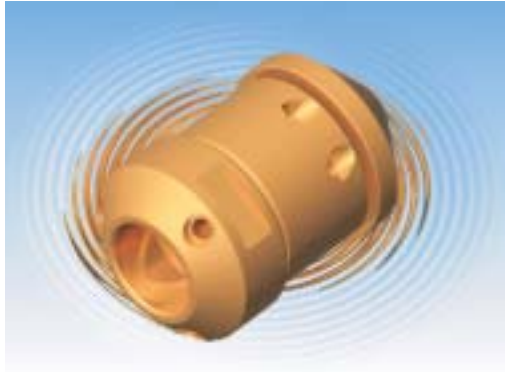

Order No.	Designation	Weight (Kg)	Dimensions L x Ø (mm)	Connection	Inserts	Scope of Application (Ø mm)
2940	RTV 22	0.15	50x22	1/8"	4 drilled	30-100
2941	RTS 22	0.15	50x22	1/4"	4 drilled	30-100
2942	RTV 28	0.20	60x28	1/4"	7 x M4x0,7 ceramic/sapphire 4 x RT / 3 x RS	40-100
2943	RTV 28	0.20	60x28	3/8"	7 x M4x0,7 ceramic/sapphire 4 x RT / 3 x RS	40-100
2944	RTV 40	0.55	83x40	1/2"	7 x M6x1 ceramic/sapphire 4 x RT / 3 x RS	70-150
2945	RTV 40	0.55	83x40	3/4"	4 x M6x1 ceramic/sapphire 4 x RT	70-150
2946	RTV 50	1.00	93x50	3/4"	7 x M6x1 ceramic/sapphire 4 x RT / 3 x RS	90-200
2947	RTV 60	1.40	103x60	3/4"	4 x RT M6x1/ 3 x RS M8x1 ceramic/sapphire	100-300
2948	RTV 60	1.40	103x60	1"	4 x RT M6x1/ 3 x RS M8x1 ceramic/sapphire	100-300
2949	RTV 100	7.40	180x100	1"	7 x M10x1 ceramic 4 x RT / 3 x RS	200-600
2950	RTV 100	7.40	180x100	1 1/4"	7 x M10x1 ceramic 4 x RT / 3 x RS	200-600
2951	RTV 150	21.50	262x150	1 1/2"	10 x M10x1 ceramic 4 x RT / 6 x RS	200-1000

RT = Rotor RS = Thrust

Nozzles Type RTS 28 / RTS 40 / RTS 50 are on request available without Thrust jets.