

MICKLEWRIGHTS STRUCTURES LTD.

24/7 Petrol Station, Telford

75 Tonnes

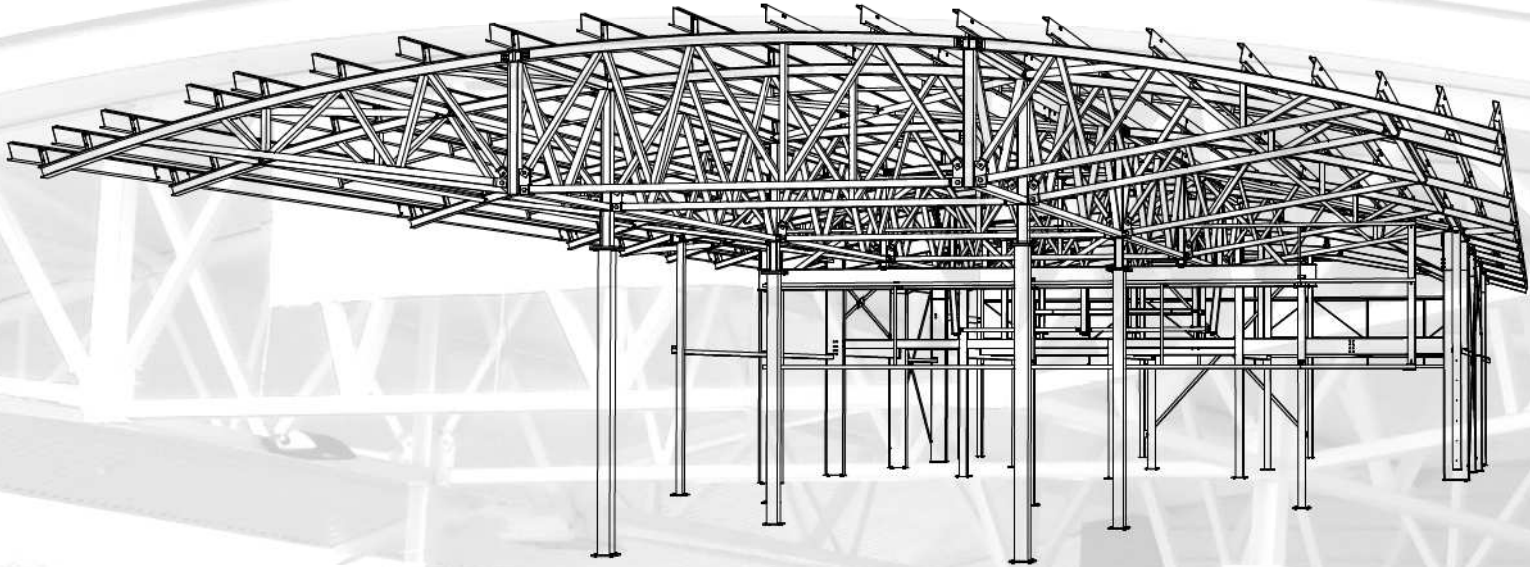

Splite into 45 tonnes of structural and 30 tonnes of truss steelwork, this project involved modifying and then extending a existing busy petrol station. One of the main client requirements was that the works must be carried out with as little disruption as possible.

By careful sequencing and coordination with the client and main contractor, we developed a scheme where we could dismantle the existing canopy, extend the existing store building rearwards and finally erected the complicated trusses over the forecourt. This was achieved without closing either the shop or forecourt at any time.



Another project completed on time and to budget

Tel: 01384 258400

E-Mail: enquiries@micklewrights.com
Unit 33, Thornleigh Trading Estate, Blowers Green, Dudley. DY2 8UB
Registered: Cardiff No. 5051416 V.A.T. Reg No. 833 3113 63

Fax: 01384 256700

