

MICKLEWRIGHTS

STRUCTURES LTD.

Project: Bohle UK

105 tonnes of Steelwork

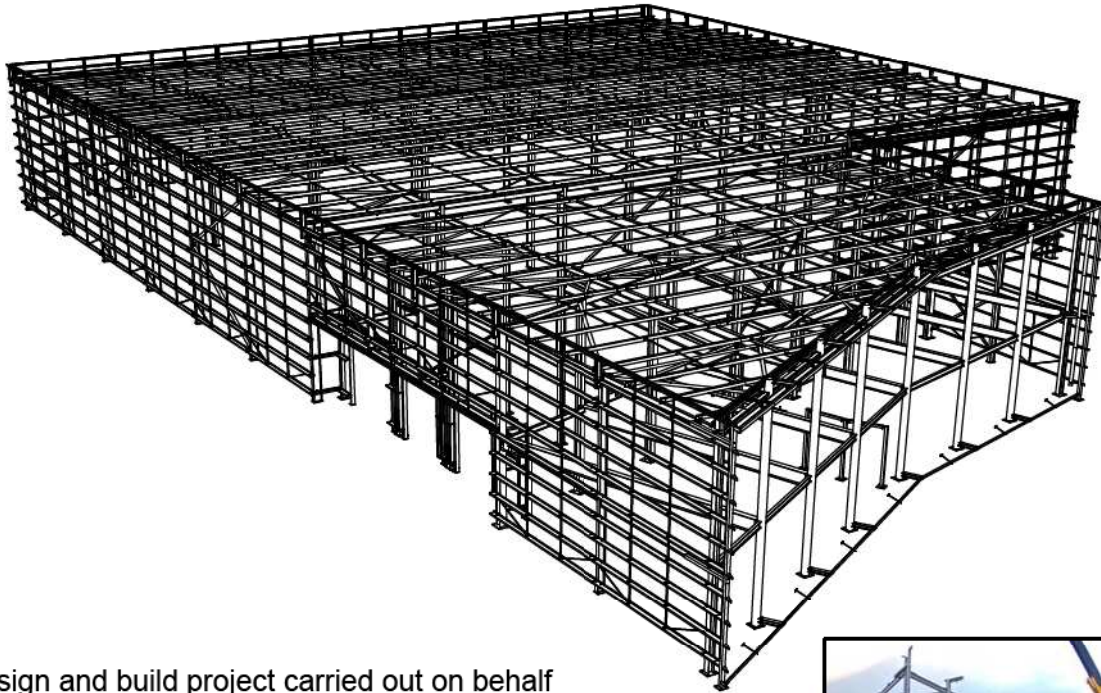

A full design and build project carried out on behalf of a local main contractor in conjunction with local Architects, Consulting Engineers and cladding Sub-Contractors.

Due to poor access the 1st half of the structure was erected, lined and levelled and handed over to allow the installation of the 1st floor pre-cast units before the 2nd half was completed.

The main entrance was required to reflect a 'picture frame' and the office roof is a 'warped construction'. The unusual cassette cladding was required to exactly replicate the head office in Switzerland.



Tel: 01384 258400

E-Mail: enquiries@micklewrights.com
Unit 33, Thornleigh Trading Estate, Blowers Green, Dudley. DY2 8UB
Registered: Cardiff No. 5051416 V.A.T. Reg No. 833 3113 63

Fax: 01384 256700

