

FOR APPROVAL

APPROVED BY: _____

DATE: _____

TIMBER FRAMED SPECIFICATION

- Roof: 750 x 38mm Timber Roof Joists
- 180 x OSB
- Mineruf Roof Blanket PVC Membrane
- External Walls: -53mm
- 0.7mm Plastic Coated Steel - Gossowing Grey
- 40x55mm Timber Frame
- 40mm High Density Polyisylene Insulation
- 12.5mm Viny Faced Plasterboard-White
- CEILING:
- 12.5mm Viny Faced Plasterboard
- 2350mm Floor to Ceiling Height
- Floors:
- Alumised Insulation Sheet
- 125 x 50mm Timber Joists
- 18mm Structural Plywood
- Non Slip Viny Floor Covering - (Woodblock Effect)
- Internal Partitions: -100mm
- 10x38mm Timber Studs
- 75mm Bees Wax Insulation
- 180 x 180mm Viny Faced Plasterboard Each Side
- Windows:
- 8 No. 450 x 450mm White PVC Double Glazed Units
- Doors:
- 2 No. 838mm Steel Banded External Doors
- 4 No. 762mm Internal Solid Core Door
- Electrical:
- 1 No. ELCB Fuse Board
- 9 No. 2x0 Lights
- 2 No. Tubular Heaters on own spurs
- Mechanical:
- 5 No. Wc
- 5 No. Wash Hand Basins
- 2 No. Urinal
- 3 No. Extractor Fans
- 2 No. Under Sink Water-heater
- 2 No. Urinal Sill Holders
- 5 No. Mirrors
- Jackknives/Trims:
- 4 No. 60mm x 60mm Steel Jackknives-Ocean Blue
- Trims- Ocean Blue

ELECTRICAL LEGEND

- ⊕ 2D LIGHT FITTING
- ⚡ EXTRACTOR FAN
- ⚡ ONE WAY SWITCH
- ⚡ FUSED SPUR
- ⚡ UNDER-SINK WATER HEATER
- ⚡ TUBULAR HEATER
- ⚡ ELCB FUSE BOARD

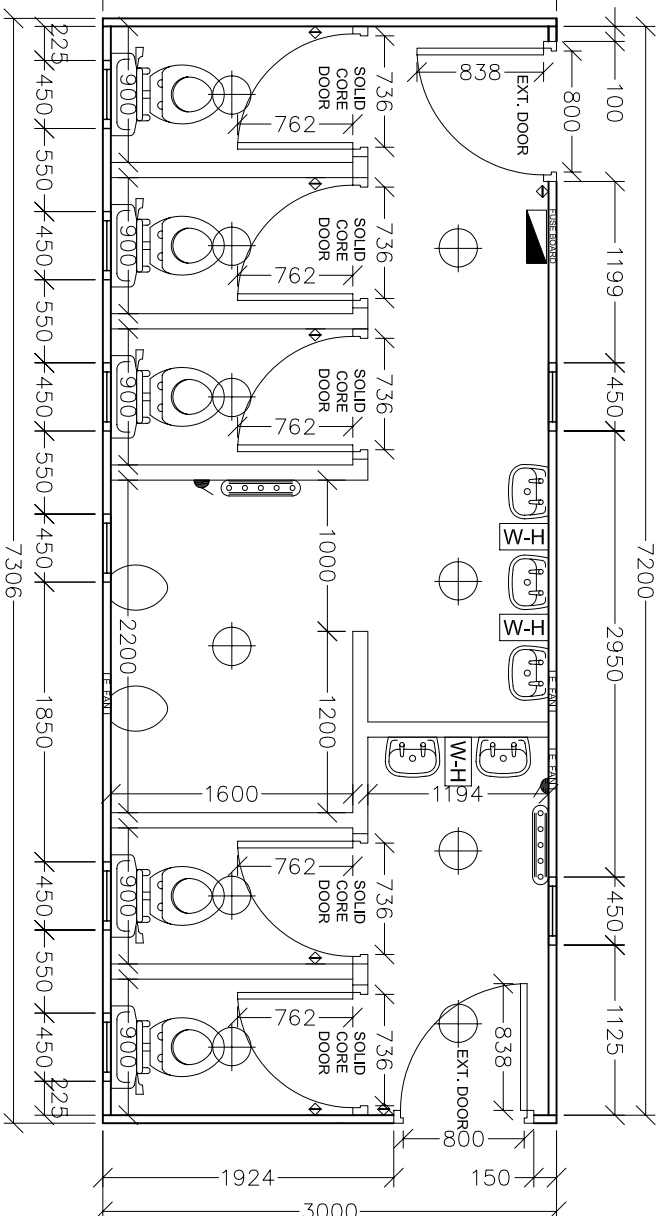
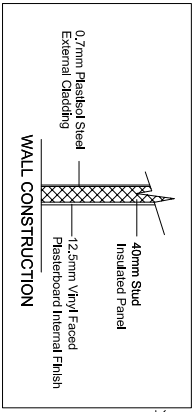
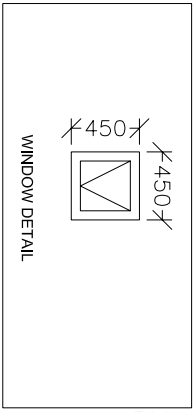

No.	Revision	Date

Convenience Services Ltd.

CSL

CSL Unit 3, Freemantle Park Farm,
Cottington Hill, Hannington RG26 5UD

Client

Project
3+2 (24' X 10') Timber Framed Toilet Block

Drawing Title
Floor Plan

Scale 1:50@A4	Drawing No. 07-F
Date Oct '07	
Drawn P. Czenthe	